

TAB Magic

ORDER INFORMATION

Short code	M54
TAB ID	189054
DIN marking	55401 SMF
Quantity per EUR/CNT pallet	72/120 Pcs

TECHNICAL INFORMATION

Voltage	12 V
Capacity C20	54 Ah
CCA -18°C EN	510 A

DIMENSION AND WEIGHTS

Length/Width/Height	207x175x175 mm
Total weight	12.3 kg

TECHNOLOGY

Type	Flooded
Grid type	Expanded/Concasted
Grid alloy	Ca/Ca
Separator	PE
Electrolyte	1.28 g/cm ³

BOX DESIGNS

Container type	L1B
Colour	Black
Base hold down	B13
Cover type	SMF
Layout	0
Terminal	1

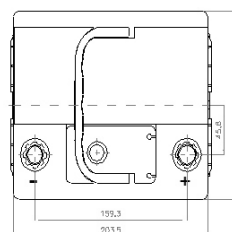
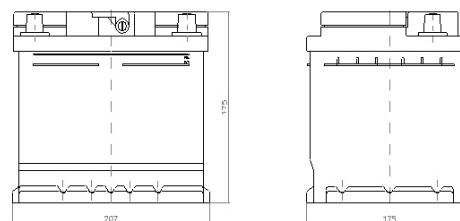

Base hold down

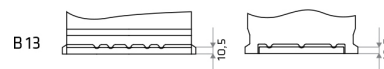

Layout

